

MADISON COUNTY SCHOOLS

Letitia H. Reeves
16th Section Land Manager

Ronnie L. McGehee
Superintendent of Education

117 Fourth Street • P.O. Box 159
Flora, Mississippi 39071
Toll Free: (800) 901-8379, Ext. 3005
Direct Line: (601) 879-3005
Receptionist: (601) 879-3000
Facsimile: (601) 879-8003
E-mail: lreeves@madison-schools.com

February 5, 2013

Madison County Board of Supervisors
ATTN: Ms. Cynthia Parker, Board Secretary
P.O. Box 404
Canton, MS 39046

RE: Documents for Board Approval

Dear Cynthia:

Enclosed please find the following documents:

1. Second Amendment to 16th Section Other Classification Property Lease to The Estes Companies, LLC, regarding Lot 1, Block 25, Jones Addition, Town of Flora, Madison County, Mississippi. NOTE: This amendment incorporates the new annual lease fee based on reappraisal.
2. Amendment to 16th Section Other Property Lease Contract to Calumet Homeowners Association, Inc. regarding Parcels A, B-1 and B-3, Calumet Subdivision, Part One; Parcel F, Calumet Subdivision, Part 2; and Parcels E, G, and H, Calumet Subdivision, Part 4. NOTE: This amendment incorporates the new annual lease fee based on reappraisal per Statutory requirements.
3. Renegotiated Other Classification Lease Contract to Entergy for Electrical Distribution Line Right-of-Way in NE1/4 NE1/4 of Section 16, Township 8 North, Range 1 West, Town of Flora, Madison County, Mississippi consisting of 0.51 acre, more or less.

It is requested that the Board of Supervisors approve the enclosed document at the upcoming Board of Supervisors' meeting to be held February 18, 2013. Should you have any questions or need anything further in this regard, please let me know. Thank you.

Sincerely,

Letitia Reeves
16th Section Land Manager

/lr

Enclosure

cc: Dr. Ronnie L. McGehee, Superintendent
Mr. Arthur Johnston, Chancery Clerk

INDEXING INSTRUCTIONS: Parcels A, B-1 and B-3, Calumet Subdivision, Part One, per Plat Cabinet D at Slide No. 57; Parcel F, Calumet Subdivision, Part Two, per Plat Cabinet D at Slide No. 22; Parcels E, G and H, Calumet Subdivision, Part 4, per Plat Cabinet D at Slide 97, encompassing in total approximately 5.8 acres, more or less, in Section 16, Township 7 North, Range 2 East, City of Madison, Madison County, Mississippi

LESSOR:

Madison County, Mississippi Board
of Education Trustees of The Madison
County School District 16th Section
School Lands Trust
P.O. Box 159
117 4th Street
Flora, MS 39071
Telephone: (601) 879-3000

LESSEE:

Calumet Homeowners
Association, Inc.
c/o Ms. Ginny Cabell
P.O. Box 394
Madison, MS 39130
Telephone: (601) _____

PREPARED BY:

Madison County School District
117 Fourth Street
Flora, MS 39071
Telephone: (601)879-3000

AMENDMENT TO 16TH SECTION
OTHER PROPERTY LEASE CONTRACT

WHEREAS, by instrument dated January 6, 2003, the **MADISON COUNTY, MISSISSIPPI, BOARD OF EDUCATION TRUSTEES** of the **MADISON COUNTY SCHOOL DISTRICT 16TH SECTION SCHOOL LANDS TRUST**

(hereinafter called "Lessor"), granted a Sixteenth Section Other Property Lease by document recorded in Book 539 at Page 455 (hereinafter the "Lease Contract") in the office of the Chancery Clerk of Madison County, Mississippi, which describes the following property, to-wit:

Parcels A, B-1 and B-3, of Calumet Subdivision, Part One, a subdivision which is on file and of record in the office of the Chancery Clerk of Madison County at Canton, Mississippi in Plat Cabinet D at Slide No. 57, reference to which is hereby made in aid of and as a part of this description.

Parcel F, of Calumet Subdivision, Part Two, a subdivision which is on file and of record in the office of the Chancery Clerk of Madison County at Canton, Mississippi in Plat Cabinet D at Slide No. 22, reference to which is hereby made in aid of and as a part of this description.

Parcels E, G and H, of Calumet Subdivision, Part Four, a subdivision which is on file and of record in the office of the Chancery Clerk of Madison County at Canton, Mississippi in Plat Cabinet D at Slide No. 97, reference to which is hereby made in aid of and as a part of this description.

WHEREAS, said Lease Contract has a lease term beginning on the 13th day of January, 2003 and ending on the 12th day of January, 2043; and,

WHEREAS, said Lease Contract requires annual rental payments in the amount of Six Hundred Five and no/100 Dollars (\$605.00), on or before January 13th each year; and

WHEREAS, lease payments have been received by Lessor in said amount for each year through 2012; and

WHEREAS, said Lease Contract, pursuant to paragraph 3, subparagraph A, states that the subject property should be reappraised prior to the tenth and twentieth and thirtieth anniversary dates of the commencement of the Lease Contract; and,

WHEREAS, the tenth anniversary date is January 13, 2013; and

WHEREAS, the subject property has been reappraised setting a new annual lease payment pursuant to paragraph 3, subparagraph A, of the Lease Contract.

THEREFORE, paragraph 2 of the Lease Contract should be amended to read as follows:

B. Lessee covenants and agrees to pay or cause to be paid to Lessor annually, on or before January 13th of each year during the term hereof, annual rentals in advance according to the following schedule:

<u>YEAR</u>	<u>ANNUAL RENTAL</u>
1-5	\$550.00
6-10	\$605.00
11-15	\$760.00 (Begins January 13, 2013)
16-20	\$836.00
21-30	As Adjusted Pursuant to Paragraph 3
31-40	As Adjusted Pursuant to Paragraph 3

Failure of Lessee to pay the annual rentals listed above shall constitute a breach of this Lease Contract.

The Lease Contract will remain in full force and effect as to all other provisions contained therein.

WITNESS MY HAND this the 4 day of February 2013.

LESSOR:

**MADISON COUNTY, MISSISSIPPI,
BOARD OF EDUCATION**

By: Shirley Simmons
Shirley Simmons, President

ATTEST:

William R. Grissett, Jr.
William R. Grissett, Jr., Secretary

Ron L McGehee

Ronnie L. McGehee, Madison County
Superintendent Of Education

LESSEE:

CALUMET HOMEOWNERS
ASSOCIATION, INC.

By: *Janie N. Jarvis*, President

Reviewed and approved by the Madison County Board of Supervisors, this the
__ day of _____, 2013.

Gerald Steen, President

ATTEST:

Arthur Johnston, Clerk

STATE OF MISSISSIPPI
COUNTY OF MADISON

PERSONALLY APPEARED BEFORE ME, the undersigned authority in and for the said county and state, on this 22 day of January, 2013, within my jurisdiction, the within named Janie Jarvis, who acknowledged to me that he/she is President of the **Calumet Homeowners Association, Inc., a Mississippi non-profit corporation**, and that for and on behalf of the said corporation, and as its act and deed, he/she executed the above and foregoing instrument, after first having been duly authorized so to do.

Marketta Norwood
NOTARY PUBLIC

My Commission Expires:
April 24, 2016
[SEAL]



STATE OF MISSISSIPPI
COUNTY OF MADISON

PERSONALLY APPEARED BEFORE ME, the undersigned authority in and for the said county and state, on this 4 day of February, 2013, within my jurisdiction, the within named Shirley Simmons, William R. Grissett, Jr. and **Ronnie L. McGehee**, who acknowledged to me that they are President, Secretary and Superintendent, respectively, of the **Madison County Board of Education**, and that for and on behalf of the said Madison County Board of Education, and as its act and deed, they executed the above and foregoing instrument, after first having been duly authorized so to do.

[Signature]
NOTARY PUBLIC

My Commission Expires:

[SEAL]



STATE OF MISSISSIPPI
COUNTY OF MADISON

PERSONALLY APPEARED BEFORE ME, the undersigned authority in and for the said county and state, on this ___ day of _____, 2013, within my jurisdiction, the within named Gerald Steen, who acknowledged to me that he is President of the **Madison County Board of Supervisors**, and that for and on behalf of the said Madison County Board of Supervisors, and as its act and deed, he executed the above and foregoing instrument, after first having been duly authorized so to do.

NOTARY PUBLIC

My Commission Expires:

[SEAL]

INDEXING: Lot 1, Block 25, Jones Addition, Town of Flora, Section 16, Township 8 North, Range 1 West, Madison County, Mississippi (Parcel #051E-16B-007).

LESSOR:

Madison County, Mississippi Board
of Education Trustees of The Madison
County School District 16th Section
School Lands Trust
117 Fourth Street
Flora, MS 39071
Telephone: 601/879-3005

LESSEE:

The Estes Companies, LLC
P.O. Box 256
Flora, MS 39071
Telephone: 601/879-3714

PREPARED BY:

Madison County School District
Post Office Box 159
117 Fourth Street
Flora, MS 39071
Telephone: 601/879-3000

**SECOND AMENDMENT TO 16TH SECTION OTHER
CLASSIFICATION PROPERTY LEASE CONTRACT**

WHEREAS, by instrument dated January 10, 1993, the **MADISON COUNTY, MISSISSIPPI, BOARD OF EDUCATION, TRUSTEES** of the **MADISON COUNTY SCHOOL DISTRICT 16TH SECTION SCHOOL LANDS TRUST** (hereinafter called "Lessor"), granted a Sixteenth Section Land Lease

Contract to the Church of God of Prophecy, which instrument was recorded in Book 352 at Page 257, in the records in the office of the Chancery Clerk of Madison County, Mississippi (hereinafter the "Lease Contract"), which leasehold was assigned to **THE ESTES COMPANIES, LLC**, a Mississippi Limited Liability Company (hereinafter the "Lessee"), by document dated March 19, 2002 and recorded in Book 507 at Page 289 in the office of the hereinbefore mentioned Chancery Clerk, which describes the following property, to-wit:

Lot 1 of Block 25 of the Jones Addition to the Town of Flora, Section 16, Township 8 North, Range 1 West, Madison County, Mississippi.

WHEREAS, said Lease Contract was amended by document dated February 14, 2003 and recorded in Book 529 at Page 206 in the office of the hereinbefore mentioned Chancery Clerk; and

WHEREAS, said Lease Contract has a lease term beginning on the 10th day of January, 1993 and ending on the 9th day of January, 2033; and,

WHEREAS, said Lease Contract requires annual rental payments in the amount of Four Hundred Eighty and no/100 Dollars (\$480.00), on or before January 10th each year, beginning with the January 10, 2003 payment pursuant to the hereinbefore mentioned Amendment; and

WHEREAS, lease payments have been received by Lessor in said amount for each year through 2012; and

WHEREAS, said Lease Contract, pursuant to paragraph (3), states that the subject property should be reappraised prior to the tenth, twentieth and thirtieth anniversary dates of the commencement of the Lease Contract; and,

WHEREAS, the twentieth anniversary date of the commencement of the Lease Contract is January 10, 2013; and,

WHEREAS, the subject property has been reappraised setting a new annual lease payment pursuant to paragraph (3) of the Lease Contract.

THEREFORE, paragraph (2) of the Lease Contract should be amended to read as follows:

Lessee agrees and covenants to pay or cause to be paid to Lessor annually, on or before January 10th of each year during the term hereof, beginning with the January 10, 2013 payment, annual rentals in advance in the amount of Five Hundred Twenty Five and no/100 Dollars (\$525.00).

The Lease Contract will remain in full force and effect as to all other provisions contained therein.

WITNESS MY HAND this the 4 day of February, 2013.

LESSOR:

**MADISON COUNTY, MISSISSIPPI,
BOARD OF EDUCATION**

By: Shirley Simmons
Shirley Simmons, President

ATTEST:

William R. Grissett Jr.
William R. Grissett Jr., Secretary

Ron L. McGehee
Ronnie L. McGehee, Madison County
Superintendent Of Education

LESSEE:

THE ESTES COMPANIES, LLC,
A MISSISSIPPI LIMITED LIABILITY
COMPANY

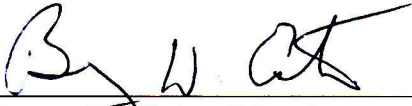
By: 
Bryan W. Estes, Member

Reviewed and approved by the Madison County Board of Supervisors, this the
___ day of _____, 2013.

Gerald Steen, President

ATTEST:

Arthur Johnston, Clerk

STATE OF MISSISSIPPI
COUNTY OF MADISON

PERSONALLY APPEARED BEFORE ME, the undersigned authority in and
for the said county and state, on this 18 day of January, 2013, within my
jurisdiction, the within named **Bryan W. Estes**, who acknowledged to me that he is
a Member of **The Estes Companies, LLC, a Mississippi Limited Liability
Company**, and that for and on behalf of the said The Estes Companies, LLC, and
as its act and deed, he executed the above and foregoing instrument, after first
having been duly authorized so to do.

NOTARY PUBLIC

My Commission Expires: _____



STATE OF MISSISSIPPI
COUNTY OF MADISON

PERSONALLY APPEARED BEFORE ME, the undersigned authority in and for the said county and state, on this 4 day of February, 2013, within my jurisdiction, the within named Shirley Simmons, William R. Grissett, Jr. and **Ronnie L. McGehee**, who acknowledged to me that they are President, Secretary and Superintendent, respectively, of the **Madison County Board of Education**, and that for and on behalf of the said Madison County Board of Education, and as its act and deed, they executed the above and foregoing instrument, after first having been duly authorized so to do.

Nettie H. Reeves
NOTARY PUBLIC

My Commission Expires: _____



STATE OF MISSISSIPPI
COUNTY OF MADISON

PERSONALLY APPEARED BEFORE ME, the undersigned authority in and for the said county and state, on this ____ day of _____, 2013, within my jurisdiction, the within named Gerald Steen, who acknowledged to me that he is President of the **Madison County Board of Supervisors**, and that for and on behalf of the said Madison County Board of Supervisors, and as its act and deed, he executed the above and foregoing instrument, after first having been duly authorized so to do.

NOTARY PUBLIC

My Commission Expires: _____

[SEAL]

INDEXING: 0.51± acre, more or less in NE1/4 NE1/4 Section 16, Township 8 North, Range 1 West, Town of Flora, Madison County, Mississippi

LESSOR:

Madison County, Mississippi Board
of Education Trustees of The Madison
County School District 16th Section
School Lands Trust
117 4th Street
Flora, MS 39071
Telephone: (601) 879-3000

LESSEE:

Entergy Mississippi, Inc.
ATTN: Richard Stevens
905 Highway 80 East
Clinton, MS 39056
Telephone: (601)925-6511

PREPARED BY:

Madison County School District
117 Fourth Street
Flora, MS 39071
Telephone: (601)879-3000

RENEGOTIATED 16TH SECTION PUBLIC SCHOOL TRUST LANDS
OTHER CLASSIFICATION PROPERTY LEASE CONTRACT
FOR ELECTRICAL DISTRIBUTION LINE RIGHT-OF-WAY

STATE OF MISSISSIPPI
COUNTY OF MADISON

THIS OTHER CLASSIFICATION PROPERTY LEASE CONTRACT
(hereinafter "Lease Contract"), made and entered into this the 30 day of January,
2013, by and between the **MADISON COUNTY, MISSISSIPPI, BOARD OF**
EDUCATION TRUSTEES OF THE MADISON COUNTY SCHOOL DISTRICT

16TH SECTION SCHOOL LANDS TRUST (hereinafter "Lessor"), and **ENTERGY MISSISSIPPI, INC.**, a Mississippi corporation (hereinafter "Lessee").

WITNESSETH:

That for the term and in consideration of the annual rentals hereinafter set forth, and the covenants, conditions, and obligations to be observed and performed by the Lessee, and by the authority and under the direction of the Madison County, Mississippi, Board of Education, Lessor does hereby lease, let and rent unto Lessee the following described land (hereinafter "Leased Premises"), to wit:

A non-exclusive easement for an overhead electrical distribution line measuring approximately 750 feet in length and 30 feet in width in the NE1/4 of the NE1/4 of Section 16, Township 8 North, Range 1 West, Madison County, Mississippi, as depicted on the plat attached hereto as Exhibit "A".

The 30 foot wide easement consists of 0.51± acres, more or less.

1. **Term.** Subject to other provisions herein contained, the term of this Lease Contract shall be for forty (40) years, beginning on the 3rd day of February, 2013, and terminating on the 2nd day of February, 2053, (the "primary term"). For purposes of this Lease Contract, the Anniversary Date shall be on the anniversary of the beginning of the primary term. It is expressly agreed and understood by all the parties hereto that part of the consideration given for the execution and delivery of this instrument is the option hereby granted to Lessee to renew this lease for an additional or "secondary term" of twenty-five (25) years as provided in §29-3-69 Miss. Code Ann. (1972), beginning on the 3rd day of February, 2053, and terminating on the 2nd day of February, 2078, at an annual rental based upon the fair market value of the land, excluding buildings and improvements not then owned by Lessor, as determined by a qualified appraiser selected by the Lessor who performs his appraisal not more than twelve months prior to the expiration of the primary term. To exercise the right to renew this lease for an additional twenty-five (25) years, Lessee must file with Lessor written notice of Lessee's intent to renew said lease. The notice to renew must be filed on or before the expiration of the forty (40) year primary term. In the event of the failure of the Lessee to exercise his right to re-lease the Property at such time, any holder of a valid first deed of trust upon the leased premises shall have a prior right to re-lease the premises at an annual rental based on appraised value, said lease to be substantially in the same form as this lease.

2. **Annual Rent.** Lessee covenants and agrees to pay or cause to be paid to Lessor a lump sum payment of \$1,050.00, which sum represents the total annual rentals due for the first ten years of the lease (\$105.00 per year). The obligation of

Lessee to pay rent under this Lease Contract is unconditional, and the rent shall not be subject to set off for any reason or cause. Lessor and Lessee agree that in the event of termination or cancellation, any rental payment made during the term of this Lease Contract is not refundable, and Lessee waives any right or claim it may have to refund of rent paid. Rents shall be paid according to the following schedule:

<u>YEAR</u>	<u>ANNUAL RENTAL</u>
1 - 10	\$ 1,050.00
11-20	\$ As Adjusted Pursuant to Paragraph 3
21-30	\$ As Adjusted Pursuant to Paragraph 3
31-40	\$ As Adjusted Pursuant to Paragraph 3

In the event Lessee is delinquent in the payment of rent, Lessee shall pay a late charge equal to fifteen percent (15%) of the amount of rent past due for more than thirty (30) days and thereafter shall pay interest on any rent past due at an annual rate (the "Default Rate") equal to the maximum rate then allowed by law or, if there is no maximum rate, than a rate equal to five percent per annum above the discount rate, excluding any surcharge thereon, on ninety-day commercial paper in effect at the Federal Reserve Bank in the Federal Reserve District in which Lessor is located, calculated according to actuarial method. Failure of Lessee to pay the annual rentals listed above shall constitute a breach of this Lease Contract.

3. Rent Adjustment Procedure.

A. Prior to the tenth (10th), twentieth (20th) and thirtieth (30th) anniversary dates of the commencement of this Lease, Lessor shall have a reappraisal made of the subject property and a re-determination of a reasonable annual rental for the property. Lessor shall, six months before or six months after any such date, cause the Leased Premises to be reappraised and a redetermination made of the annual fair market rental amount. The reappraisal shall be made pursuant to the terms of § 29-3-65 Miss. Code Ann. (1972), or pursuant to the statute then in effect governing such leases and procedures for determining fair market rental value. Lessor shall use its best efforts to cause the Leased Premises to be reappraised and a redetermination made of the annual fair market rental amount within six months before expiration of the primary term. In the event Lessor shall fail to instigate reappraisal within the six months preceding any rent adjustment date, Lessor shall not be deemed to have waived this provision requiring rent adjustment, and in such event (at any time after a rent adjustment date) Lessor may proceed to have the Leased Premises reappraised and an adjusted rent determined for any such readjustment period. The adjusted rent shall be effective on the required adjustment date and Lessee shall pay any deficiency to Lessor within fifteen (15) days of the determination of the adjusted rent. The reappraisal shall establish the fair market value of the Leased Premises and establish a reasonable current percentage of income

on real estate investments for the purposes of determining annual fair market rental. Such percentage shall be no less than the minimum acceptable percentage provided by statute then in effect. Unless altered by the procedures described below, the amount of rent so determined as of each rental adjustment date shall be paid until the next rental adjustment date or for the balance of the lease as the case may be. The appraisal process described in this subparagraph may be referred to hereafter as the Statutory Procedure. The cost of the reappraisal shall be borne by Lessee, using an appraiser selected by Lessor.

The Lessor shall notify Lessee of the reappraisal in writing a minimum of ninety (90) days prior to said dates. The reappraisal shall establish the fair market value of the property and the fair return on value for rent. Buildings and other improvements on the property, which are not owned by Lessor shall be excluded from the reappraisal evaluation. The amount of the annual rental so determined as of the tenth (10th) anniversary date shall be paid annually for the next succeeding ten (10) years; the annual rental so determined as of the twentieth (20th) anniversary date shall be paid annually for the next succeeding ten (10) years; and the annual rental so determined as of the thirtieth (30th) anniversary date shall be paid annually for the balance of the Lease term.

i) Any adjustments of annual rental determined by the above-mentioned statutory appraisal procedure shall be binding upon the Lessor and Lessee.

ii) The annual rental on any adjustment date shall not be reduced below the amount established upon the initial date of this Lease except upon determination by the Statutory Procedure.

B. Should the Statutory Procedure described in subparagraph (A) above result in an increase over the amount previously due, Lessee, by notice in writing given to the Lessor within fifteen (15) days after receiving notice of the increase, shall have the right to elect an alternate method of determining the current fair market rental value of the Leased Premises (the "Alternate Procedure") as follows:

(i) Lessee may provide an appraisal by an appraiser having the qualifications hereafter described giving an opinion of current fair market annual rental value based on the fair market value of the land and a reasonable percentage of return on comparable land investments as of the rental adjustment date. The written report of Lessee's appraiser shall be delivered to Lessor within 45 days after the date on which Lessor gave notice of an increase in rent under the Statutory Procedure. UPON FAILURE TO PROVIDE AN ALTERNATE APPRAISAL WITHIN THE TIME ALLOWED, LESSEE SHALL FORFEIT THE RIGHT TO PURSUE THE ALTERNATE PROCEDURE, AND ANNUAL RENT DETERMINED UNDER THE

STATUTORY PROCEDURE SHALL BECOME DUE AND PAYABLE.

(ii) The appraiser appointed by Lessee and the appraiser previously appointed by Lessor under the Statutory Procedure shall make a good faith effort to reconcile their differences. If they have been unable to do so within 10 days after delivery of the report of Lessee's appraiser, the two appraisers, within such 10-day period, shall each submit the names of three appraisers having the qualifications hereinafter described who practice in Mississippi to serve as a review appraiser, and they shall select the review appraiser from names in common on the two lists. If there is no name in common on the two lists, or if the person selected shall decline to serve, then each appraiser shall submit another list of three names of persons meeting the same criteria.

(iii) The review appraiser shall review and analyze the two appraisal reports, and, if needed, inspect the land, consult with the two appraisers, review their assumptions and source informational and request corrections, revisions and additions to the appraisal reports. The review appraiser may also consider relevant information from his own files, conduct such independent investigation as he deems appropriate and may consider comparable transactions which occurred after the rental adjustment date.

(iv) The review appraiser shall report his opinion of annual fair market rent and such amount shall be accepted by Lessor and Lessee as the current fair market rental value of the Leased Premises.

C. If Lessee requests the Alternate Procedure, Lessee shall pay all fees and expenses of Lessee's appraiser, the review appraiser and any additional charges of Lessor's appraiser. The review appraiser, however, shall perform his duties in an independent and impartial manner irrespective of the source of payment of his fees and expenses.

D. The annual rentals on any adjustment date shall not be reduced below the amount established upon the initial date of this lease except upon determination by the Statutory Procedure.

E. The amount of rent determined in the above manner shall be remitted on or before the rental adjustment date, or, if the rental adjustment procedures are concluded after such date, then promptly upon conclusion of these rental adjustment procedures effective as of the rental adjustment date.

F. The rent adjustment procedures will not delay the due date of rent at the existing annual rate and will not affect Lessor's right to declare a default if rent is not timely paid.

G. Lessee's appraiser and the review appraiser must be members of the same organization of appraisers as Lessor's appraiser, or an organization having higher requirements for admission, and must have the same or higher designation (such as, for example, Member, Appraisal Institute). If Lessors's appraiser belongs to more than one organization, the other appraisers must belong to the organization having the highest standards and qualifications for membership. If the organization has multiple designations for appraisers, the review appraiser and the Lessee's appraiser must hold the same or a higher designation as held by Lessor's appraiser.

4. **Taxes.** Lessee covenants and agrees to pay any and all general and special taxes and assessments, including drainage taxes, if ever any there be, applicable to the Leased Premises and Lessee's interest therein; Lessee covenants and agrees to pay any and all survey costs and recording fees in connection with this Lease Contract or any other fees so determined by law. All payments for general and special taxes and assessments shall be made directly to the governmental authority responsible for collecting such taxes and assessments. During the final year of the lease term, Lessor or the governmental authority responsible for collecting taxes and assessments may require payment of any such taxes or assessments, including drainage taxes, in advance or require that other security be given to insure that taxes will be paid when due. In the event it becomes necessary for the County Tax Collector or any other authority responsible for collecting general and special taxes or assessments to retain the services of attorneys to collect any taxes or assessments due from Lessee under this lease, then Lessee agrees to pay all costs and expenses of such actions or collections, including a reasonable attorneys' fee for the County Tax Collector or such other authority responsible for collecting said taxes or assessments. Lessee's failure to pay said taxes, as and when due, shall constitute a breach of this Lease Contract and shall entitle Lessor to terminate this lease.

5. **Default.** The parties herein expressly agree that if default shall be made in the payment of any general or special tax or assessment or rent due, made pursuant to this Lease Contract, then and in any event of default, it shall be lawful for Lessor to enter upon the Leased Premises, or any part thereof, after Lessor has provided sixty (60) days prior written notice to Lessee and upon Lessee's failure to cure such default within said sixty (60) days, either with or without the process of law, to re-enter and repossess the same, and to distraint from any rent or assessment that may be due thereon, at the election of Lessor, but nothing herein is to be construed to mean that Lessor is not permitted to hold Lessee liable for any unpaid rent or assessment to that time. As to all other conditions, covenants, and obligations imposed on Lessee herein, enforcement shall be by proceeding at law or in equity against any person violating or attempting to violate said conditions, covenants, and obligations to restrain violation and recover damages, if any, including reasonable expenses of litigation including, but not limited to, fees charged by attorneys, expert

witnesses, surveyors and appraisers, which Lessee expressly agrees to pay. Such enforcement by proceedings at law or in equity may be instituted at any time after sixty (60) days written notice. Enforcement proceedings shall include the right of the Tax Collector to recover any tax, assessment, fees and costs. Invalidation of any provision(s) of this Lease by judgment or court order shall in no way affect any of the remaining provisions which shall remain in full force and effect.

6. **Remedies.** In the event of any forfeiture, default, or cancellation of this Lease Contract or termination of the term therefore aforesaid, Lessee shall quit, deliver up and surrender possession of the Leased Premises, and all Lessor-owned structures and improvements thereon to the said Lessor, and thereupon this Lease Contract and all agreements and covenants on Lessor's behalf to be performed and kept, shall cease, terminate, and be utterly void, the same as if the Lease Contract had not been made. At Lessor's option, Lessee shall be required to remove all Lessee-owned improvements. In addition thereto, Lessor shall be entitled to whatever remedies it may have at law or equity for the collection of any unpaid rental hereunder, or for any other sums, for damages or otherwise, that it may have sustained on account of Lessee's non-fulfillment or non-performance of the terms and conditions of this Lease Contract, including costs for removing Lessee-owned improvements.

Immediately upon the termination of this Lease Contract, whether for forfeiture, default or cancellation, Lessor shall be entitled to take possession of the Leased Premises and all Lessor-owned improvements thereon absolutely, notwithstanding custom, usage, or law to the contrary. Any removal of property from the Leased Premises shall be accomplished so as to leave the Leased Premises in a condition satisfactory to Lessor. Lessee shall remove all of Lessee's property within one hundred and eighty (180) days of the said event. Lessee shall be subject to the accrual of rent during said one hundred and eighty (180) days.

7. **Curing Default.** Notwithstanding any provision of this Lease to the contrary, any present or future holder of a mortgage or a deed of trust representing money loaned on these facilities, shall have the right of a thirty (30) day notice of default within which to cure any default which may be cured by the payment of money. In addition, for any other default for which a forfeiture of said Lease Contract may be invoked, such holder of such mortgage or deed of trust shall be entitled to a notice in writing of the claimed default and shall have a reasonable time, which shall not be less than sixty (60) days, either to require the correction of such default or in lieu thereof, to protect itself through the exercise of a power of sale and thereby acquire a leasehold in the Leased Premises and correct such default. Lessee hereby covenants and agrees to notify Lessor of the existence of all such mortgages, deeds of trust, or other secured encumbrances, and that, in the absence of such notice, Lessor has no obligation whatever to notify any such holder of said encumbrance.

Any recorded mortgage or deed of trust may provide that any default by the Lessee/Mortgagor concerning this Lease shall likewise be a default of such mortgage or deed of trust, but failure to indicate such provisions in any mortgage or deed of trust shall not affect the validity or propriety thereof nor diminish the protection extended to the holder of such mortgage or deed of trust or the indebtedness secured thereby.

8. **Assignment.** Provided Lessee is not in breach of this Lease Contract, Lessee may, upon payment of a \$200.00 transfer fee to Lessor shall have the full right and authority to lease, sell, assign, transfer and/or convey to others this lease in whole and to encumber the same. However, any lease, sale, assignment, transfer or conveyance shall be subject to the prior written consent of Lessor which shall not be unreasonably withheld, and to the required consent and additional requirements, if any, of the Secretary of the State of Mississippi or other applicable government officials. Consent shall not be required for an encumbrance of, or lien on, the leasehold estate, or for an assignment, transfer or conveyance by Lessee to a subsidiary, affiliate or related company of Lessee or one of its original members, or as part of the sale, transfer or conveyance of at least fifty (50) percent of the assets or equity of the Lessee, or assignments in connection with a lease financing. The Lessor agrees to execute such documents as reasonably may be requested by any lender or other assignee to evidence and acknowledge the effectiveness of any such assignment.

9. **Regulatory Compliance.** Lessee shall comply with all applicable laws, rules, and regulations concerning Lessee's use of the property and/or obligations under this Lease Contract. This obligation shall include, but not be limited to, compliance with federal, state and local environmental regulations concerning the air, water and soil, endangered species, wetlands, and other laws, rules and regulations that may presently exist or hereafter be adopted. In the event of contamination of the air, water or soils arising out of any Lessee use, Lessee shall be responsible for all mandated remediation and monitoring with this obligation to survive termination of this Lease Contract. Notwithstanding the requirements of this paragraph, Lessee:

A. Will not sue, generate, manufacture, produce, store, release, discharge, or dispose of , on, under or about the Leased Premises or transport to or from the Leased Premises any hazardous substance or pollutant (as either may be defined by an present or future laws or regulations of any governmental authority or by an administrative or judicial decisions) or any solid wastes and will not allow any other person to do so.

B. Shall keep and maintain the Leased Premises in compliance with, and shall not cause or permit the Leased Premises to be in violation of, any environmental laws or regulations nor any laws or regulations pertaining to the disposal of solid,

liquid, or gaseous wastes, both hazardous and non-hazardous.

C. Shall give prompt written notice to Lessor and the Secretary of State of:

(i) Any proceeding or inquiry by any governmental authority with respect to the presence of any solid wastes or hazardous substance on the Leased Premises or the migration thereof from or to other property;

(ii) All claims made or threatened by any governmental authority with respect to the presence of any solid wastes or hazardous substance on the Leased Premises or the migration thereof from or to other property.

(iii) Lessee's discovery of any occurrence or condition that would cause the Leased Premises to be subject to any restrictions on the ownership, occupancy, transferability or use of the Leased Premises under any environmental or solid waste disposal law, regulation, ordinance or ruling.

10. **Environmental Accidents.** Lessee shall immediately furnish written notice of all spills, leaks, accidents or similar matters on the premises to Lessor and the Secretary of State at the addresses provided in this instrument. Lessee shall also furnish Lessor and the Secretary of State a copy of all filings, including but not limited to, environmental issues, required bylaws, rules or regulations arising out of any spills, leaks, accidents, or other matters related to the use and occupation of the premises by Lessee. Nothing in this paragraph shall place any duty of cleanup or remediation of property upon Lessor, with those duties belonging exclusively to Lessee. Lessee shall be responsible for all mandated remediation and monitoring with this obligation to survive termination of this Lease Contract.

11. **Breach of Lease Contract.** If Lessee breaches any of the provisions of this Lease Contract and fails to cure the same after sixty (60) days written notice from the Lessor, then Lessee, in addition to any other damages for which it may be responsible, shall pay Lessor, its reasonable costs and expenses in enforcing the Lease Contract, including but not limited to, fees charged by attorneys, expert witnesses, surveyors and appraisers.

12. **Notices.** All notices specified by this instrument shall be in writing and sent by registered or certified mail, postage prepaid, to the following address or hand-delivered in person, delivered by facsimile or otherwise to the following persons. By written notice, either party may change the persons or addresses to who notice shall be sent.

To Lessor: 16th Section Land Manager
Madison County School District
117 Fourth Street
Flora, MS 39071
Telephone: (601)879-3000
Facsimile: (601)879-8093

To Secretary of State: Mississippi Secretary of State's Office
ATTN: 16th Section Lands
P.O. Box 136
Jackson, MS 39205-0136
Telephone: (601)359-1350
Facsimile: (601)359-1461

To Lessee: Entergy Mississippi, Inc.
ATTN: Richard Stevens
905 Highway 80 East
Clinton, MS 39056
Telephone: (601)925-6511

13. **Insurance.** Lessee shall maintain contractual and comprehensive general liability insurance with a company acceptable to Lessor and the Secretary of State, with a minimum combined single limit of liability of one million dollars (\$1,000,000.00) [and the members of Lessee shall collectively maintain a similar policy or self-insure for an excel limit of liability of one million dollars (\$1,000,000.00)] for personal injuries or death of persons or destruction of property arising out of any pipelines that are subject to his instrument. Lessee shall furnish proof of insurance (or self-insurance for Lessee's members, if applicable) to Lessor, shall keep this insurance (or self-insurance for Lessee's members, if applicable) in full force and effect, and shall furnish Lessor notice if the coverage is placed with another insurance company (or if the self-insurance for Lessee's members is managed by another company, if applicable). The amount of this instrument shall be adjusted for inflation every ten years on each tenth anniversary of this instrument according to the procedures then set forth by the Office of the Secretary of State of Mississippi.

14. **Indemnification.** Lessee shall protect, indemnify, defend, save, and hold harmless Lessor, the Secretary of State and the State of Mississippi, its officers, board members, employees and agents, from and against all claims, demands, liabilities, suits, injuries, and any and all losses or damages and cost of every kind and nature whatsoever ("loss"), including but not limited to, all court costs and attorney fees and all personal injury or death and/or damage to any person or entity including, but not limited to, Lessor and its property or other loss arising out of any

alleged noncompliance with laws or caused by Lessee's exercise of its rights under this Lease Contract and/or resulting from the actions or omission of Lessee in connection with its presence on or any use of the Leased Premises by Lessee, its officers, agents, subcontractors, employees or invitees. Provided, however, it is understood that the indemnity provided by Lessee as described in this paragraph shall not extend to intentional or negligent acts of Lessor, its officers or agents. In the event the intentional or negligent acts of Lessor, its officers or agents, are not the direct or sole proximate cause for one hundred percent (100%) of the loss of claim, Lessee shall be responsible to fulfill its obligations under this paragraph for the percentage of liability not attributable to Lessor, its officers or agents.

15. **Mortgage Transactions.** The preceding restrictions on assignments of this lease shall not apply to, and no prior approval of Lessor shall be required for: (i) a mortgage of the leasehold estate; (ii) a foreclosure or an assignment of the leasehold estate to the mortgagee in lieu of foreclosure; or (iii) a transfer by a mortgagee who has acquired the leasehold estate and such transfer occurs within a reasonable period of time commensurate with liquidation of the asset. However, any person acquiring the leasehold estate by any of the above means shall be obligated, within ten (10) days thereafter, to provide Lessor with a copy of the recorded assignment. No mortgagee shall be deemed to have assumed, and no mortgagee shall be personally obligated to perform any of Lessee's obligations under this lease which accrued prior to acquisition of the leasehold estate, provided that this limitation on personal liability shall not diminish the rights and remedies otherwise available to Lessor in the event of a default nor the right of a mortgagee to cure defaults as herein provided. A mortgagee, having acquired the leasehold estate through foreclosure or assignment in lieu of foreclosure, shall be liable for performance of all obligations of Lessee which accrue during the period the mortgagee has ownership of the leasehold estate, and any rent payment which becomes due during such period shall be paid in full and not pro-rated. Nothing contained in this Lease Contract or in any mortgage shall release Lessee from the full and faithful performance of Lessee's obligations under this Lease Contract or from any liability for non-performance or constitute a waiver of any right of Lessor against Lessee. The term "mortgage" as used in this paragraph means any mortgage, deed of trust, collateral assignment or other transfer or pledge of this lease as security for an indebtedness of Lessee; and the term "mortgagee" means the holder of the indebtedness to whom or for whose benefit this Lease Contract has been mortgaged or pledged as security.

Notwithstanding any provision of this Lease Contract to the contrary, in the event of a default and foreclosure of a mortgage or deed of trust representing money loaned on the hereinbefore described property or the receipt of a transfer in lieu thereof, the purchaser at such foreclosure or the recipient of a transfer in lieu thereof, will receive all the rights and privileges of a lessee and likewise assume all responsibilities of a lessee as if such purchaser or transferee had initially been a

lessee under this Lease Contract.

16. **Waste.** The Lessee shall be responsible for any damage that may be caused to Lessor's property by the activities of the Lessee under this Lease Contract, and shall exercise due diligence in the protection of all improvements, timber and other property of Lessor, which may be located on the Lease Premises or in the vicinity thereof, against fire or damage from any and all other causes. Lessee shall further comply with all applicable laws, rules and regulations concerning Lessee's use of the property and/or obligations under this Lease Contract. This obligation shall include, but not be limited to, compliance with federal, state and local environmental endangered species, wetlands, and other laws, rules and regulations that may presently exist or hereafter be adopted. If the Lessee shall commit, cause to be committed, or permit the commission of any act of waste on the leased premises, then this lease shall thereupon cease and terminate and shall thenceforth be null and void, and the Lessee shall be and remain liable to Lessor for any and all waste and damages to the land permitted, done, or in any way caused by the Lessee. In the event of contamination of soils, air or water arising out of any Lessee use,

17. **Quiet Possession.** Lessee shall have quiet and peaceful possession of the Leased Premises as long as compliance is made with terms of this Lease Contract.

18. **Bankruptcy or Judgments.** Lessee hereby covenants and agrees that if an execution or process is levied upon the Leased Premises or if a petition of bankruptcy be filed by or against Lessee in any court of competent jurisdiction, Lessor shall have the right, at its option, to cancel this Lease Contract. Lessee further covenants and agrees that this Lease Contract and the interest of Lessee hereunder shall not, without the written consent of Lessor first obtained, be subject to garnishment or sale under execution or otherwise in any suit or proceeding which may be brought against said Lessee.

19. **Condemnation.** If the whole of the Leased Premises, or such portion thereof as will make the Leased Premises unsuitable for Lessee's normal business activity, should be condemned for any public use or conveyed under threat of condemnation, then this Lease Contract shall terminate on the date possession is acquired by the condemning authority, and rent shall be apportioned as of that date. All compensation awarded or paid upon such total or partial taking of the Leased Premises shall belong to Lessor without participation by Lessee, except to the extent the award fairly represents the value of improvements which are the property of the Lessee. It is provided, however, that nothing herein shall preclude Lessee from prosecuting any claim directly against the condemning authority for loss of business, cost of relocation or any other amounts to which a tenant may be entitled, provided that no such claim shall diminish or otherwise adversely affect the amount of Lessor's award.

20. **Classification/Use.** The lands herein have been classified as Other in accordance with §29-3-31, et seq., Miss. Code Ann. (1972), as amended. Lessor warrants that the Leased Premises shall be permitted to be used for a electrical distribution right-of-way for the duration of the term. This warranty does not apply to any change in use which may be required by governmental authority or other means beyond the control of Lessor. This distribution line easement shall be for the distribution of electricity to lessees located within Section 16, Township 8 North, Range 1 West, Madison County, Mississippi as well as adjacent landowners.

Lessee may construct, maintain, operate and repair, fiber optic or other communication lines, electric power facilities and all appliances, appurtenances, fixtures and equipment deemed by Lessee to be necessary or desirable in connection only with the operation of said electrical distribution right-of-way, on, over, across, along, under and through the subject property.

Lessee shall not use the Leased Premises for any of the following purposes: (i) activities that are considered hazardous, including, but not limited to, demolition or the storage or use of dangerous substances; (ii) Any activity considered to be a nuisance; (iii) Any activity that is unlawful or immoral; (iv) The operation of a business or proprietorship that offers adult entertainment including, but not limited to, nude or partially nude dancing or display or the sale or distribution of adult materials including, but not limited to, pornographic magazines, books, videocassettes, or computer disks; (v) Any activity which at the discretion of the Lessor and the Secretary of State is inappropriate upon Sixteenth Section Land.

21. **Successors.** To the extent assignment of this Lease Contract is allowed by the above provisions, this Lease Contract shall be binding upon Lessee's successors and assigns.

22. **Buildings or Improvements.** While this Lease Contract continues in force and effect, Lessee shall have the unrestricted right to remove, change, alter, modify, add to or subtract from any of Lessee's fixtures on the land as the Lessee may in its sole discretion elect so to do, and the Lessor, while this Lease or any extension thereof continues in force and effect, shall have no possessory interest in any of Lessee's fixtures or improvements. If any of Lessee's improvements are removed, the Lessee shall be obligated to remove all foundations and paved areas, fill any excavations with a soil material suitable as a foundation support for further construction and generally restore the premises to a condition suitable for construction, use and occupancy by others. Lessee shall have the right to construct new or replacement buildings or structures on the leased premises. In the event construction is contemplated, Lessee shall submit a description of the general nature of the proposed improvement and its intended use to Lessor for approval, which approval shall not be

unreasonably withheld.

It is expressly agreed by and between the parties that Lessee will not make any alteration upon the Leased Premises without the express written consent of Lessor and that Lessee will not occupy or use, nor permit to be occupied or used, the Leased Premises, for any business deemed extra-hazardous on account of fire or otherwise; nor will Lessee permit the same to be used for any immoral or unlawful purpose. Lessee also covenants and agrees to maintain the Leased Premises in a neat and orderly manner and to refrain from creating or maintaining any eyesores, unattractive nuisances, or other nuisance.

23. **Diligence.** The Lessee shall be responsible for any damage that may be caused to Lessor's property by the activities of the Lessee under this Lease, and shall exercise due diligence in the protection of all improvements, timber and other property of Lessor, which may be located on the lease premises or in the vicinity thereof, against fire or damage from any and all other causes.

24. **General Duties of Lessee.** Lessee agrees:

A. To comply with all laws and ordinances applicable to the use of the Leased Premises including, without limitation, laws and regulations pertaining to accessibility by handicapped persons.

B. To allow inspection of the Leased Premises during normal business hours by an persons responsible for management or supervision of the property or this Lease Contract acting in their official capacity.

C. To perform all obligations herein expressed in a prompt fashion, without notice or demand.

D. To surrender the Leased Premises upon termination or expiration of this Lease Contract, with improvements to be in the condition as herein specified.

E. To provide Lessor, at each Anniversary Date, written certification by Lessee or an officer of Lessee, of compliance with the provisions of this Lease Contract.

F. To maintain the Leased Premises at all times in a clean, neat and orderly manner, free of waste materials, and to keep grass and other vegetation clipped.

25. **Reservation.** Lessor reserves title to all oil, gas, coal, lignite and other

minerals, in on, or under the Leased Premises, together with the right of ingress and egress to remove the same, but not in a manner which interferes with Lessee's operations on the Leased Premises.

Lessor reserves the right to lease the property for any other purpose not inconsistent with this agreement pursuant to applicable laws, rules and regulations concerning sixteenth section lands in effect at the time, including but not limited to agricultural, forestry, hunting or otherwise make use of the subject property for purposes and in a manner which will not interfere with the enjoyment or use of the rights and estate granted herein, but Lessor shall not construct, nor permit to be constructed, any houses, buildings, dams, levees, lakes, ponds, structures, or any similar or dissimilar obstructions on or over said leasehold, or any part thereof, as surveyed or finally determined hereunder without the prior written consent of Lessee. Any use of the property for forestry purposes shall not authorize Lessor to plant or otherwise grow or manage trees or timber upon the leasehold and shall be subject to Lessee's right to clear the leasehold without the payment of additional consideration. Nothing in this paragraph shall be construed to prohibit Lessor from constructing a road or laying other utilities over and across the leasehold. Lessor shall, however, provide Lessee at least ninety (90) days written notice prior to the construction or any roads to allow Lessee to take such measures as deemed reasonable and necessary to protect the electrical distribution line.

26. **Rights-of-Way**. Lessor reserves the right to grant or sell easements and rights of way on, over and across the Lease Premises for roads, highways, railroads, fiber optic cables or any public utility line, provided that any such roads, highways, railroads, fiber optic cables or public utility lines be constructed in a manner so as not to interfere with Lessee's operations. This, however, is not to prevent Lessee from collecting from any utility company for any damage which may be sustained by Lessee in the construction, operation or maintenance of utilities on such right of way or easement.

27. **Recording**. Lessor will deliver this Lease Contract to the Chancery Clerk of Madison County for recording and Lessee has herewith delivered to Lessor a check payable to such Chancery Clerk for the recording fees.

28. **Immunity**. No provision of this Lease Contract, whether requiring Lessee to indemnify Lessor or otherwise, shall be construed as a waiver by Lessor or the Secretary of State of any provision of law related to governmental immunity.

29. **Interpretation**. The parties to this Lease Contract acknowledge that they have freely entered into this Lease Contract and any ambiguities shall not be construed against a single party.

30. **Definition of Lessee.** It is further stipulated and agreed that wherever the word "Lessee" is used herein, it is intended and shall be deemed, to include and shall be binding upon Lessee's members, agents, servants, employees, contractees, invitees, licensees, and guests.

31. **Governing Law.** This Lease Contract shall be governed by, construed, and enforced in accordance with the laws of the State of Mississippi. Jurisdiction and venue for any actions arising from this Lease Contract and any amendments hereto shall rest exclusively in the Chancery Court of Madison County, Mississippi.

32. **Secretary of State.** By virtue of the signature below, the Secretary of State of the State of Mississippi has approved this Lease Contract in accordance with the Secretary's authority for general supervision of 16th Section Public School Trust Land. Approval of this Lease Contract by the Secretary of state indicates that the Madison County Board of Education has exercised the care and skill of an ordinary prudent person to protect the beneficiaries of the 16th Section Public School Trust Land.

33. **Supervisory Right.** The Secretary of State, as supervisory trustee, shall have the right to institute any action to enforce the terms of this Lease Contract in the event Lessor fails to do so in a timely manner. In the event the Secretary of State institutes legal action to enforce the terms of this Lease Contract, he shall have all rights as are conferred to Lessor.

34. **Entire Agreement.** This Lease Contract shall constitute the entire agreement between the parties. Any prior understanding or representation of any kind preceding the date of this Lease Contract shall not be binding upon either party except to the extent incorporated herein.

35. **Zoning Ordinances and Restrictions.** This Lease is subject to the City of Madison, Mississippi zoning and subdivision ordinances, which conditions shall be in full force and effect as to the property leased herein.

36. **Timber.** The parties recognize that the subject property must be cleared of all timber for Lessee to use the subject property for its purposes. After said initial cutting, Lessee shall have continuing right, exercisable at any time, and from time to time, to cut and keep the subject property clear of all trees, undergrowth, and any other natural or manmade objection that may injure or endanger any of the above-described facilities or interfere with Lessee's access to, monitoring of, or maintenance, repair, relocation for maintenance purposes, construction, and/or operation of the same, all without further compensation other than the annual rental payments specified herein.

37. **Surface Damages.** Lessee shall pay for all damages to Lessor's roads, fences,

crops, timber, soils, ground eater, surface water and property or natural resources that may be suffered by Lessor by reason of the exercise of Lessee of any of the rights and privileges hereby granted, but shall not be liable for keeping the subject property clear of trees, undergrowth, and other natural or man-made obstructions in the course of the maintenance and operation of its systems and appurtenances. Lessee shall not pollute or otherwise contaminate the land, air, water and resources of Lessor and adjacent owners shall immediately remedy any pollution or contamination, should it occur.

38. **Access.** This lease shall include, without limitation, the right of convenient ingress and egress by Lessee over and across the adjoining land of Lessor by the use of existing public roads, whether presently existing or hereafter publicly constructed and maintained, and the use thereof, reasonably necessary in connection with the construction, maintenance, operation, removal, repair, renewal, replacement, or removal of the above-described facilities on said tract. Any damage to the roadways shall be repaired by Lessee within fifteen (15) days of prior receipt of notice by Lessor. Such access shall be limited to public roadways in existence at the time access is needed. Lessor reserves the right to close or relocate roadways without notice to the Lessee. Lessee shall have the right of ingress and egress to and from said Right-of-Way easement across the adjoining land of the Lessor, subject to any rights of surface lease holders thereon, and the right to attach power lines of any other party to the Lessee's facilities.

39. **Quitclaim Of Previous Lease.** Lessee does hereby release, assign, quitclaim and convey unto Lessor all its rights, title and interest in and to that certain lease instrument recorded in Book 531 at Page 241 in the records in the office of the Chancery Clerk of Madison County, Mississippi.

IN WITNESS WHEREOF, this Lease is executed by Lessor pursuant to the Order duly entered upon its Minutes.

LESSOR:

**Madison County, Mississippi Board
of Education Trustees of the Madison
County School District 16th Section
School Lands Trust**

By: Shirley Simmons
Shirley Simmons, President

ATTEST:

Ronnie L. McGehee
Ronnie L. McGehee, Madison County
Superintendent of Education

LESSEE:

**Entergy Mississippi, Inc., a Mississippi
Corporation**

By: Hal D. Haddon
HAL D. HADDON (Print Name)
AREA DESIGN MANAGER (Title)

APPROVED:

C. Delbert Hosemann, Jr.
Secretary of State

Reviewed and approved by the Madison County Board of Supervisors, this the ___ day of _____, 2013.

Gerald Steen, President

ATTEST:

Arthur Johnston, Clerk

STATE OF MISSISSIPPI
COUNTY OF HINDS

PERSONALLY APPEARED BEFORE ME, the undersigned authority in and for the said county and state, on this 30 day of JANUARY, 2013, within my jurisdiction, the within named Hal Haldon, who acknowledged to me that he/she is Area Design Manager of **Entergy Mississippi, Inc., a Mississippi corporation**, and that for and on behalf of the said Entergy Mississippi, Inc., and as its act and deed, he/she executed the above and foregoing instrument, after first having been duly authorized so to do.

Ray A. Steele
NOTARY PUBLIC

My Commission Expires:
3-13-2015
[SEAL]



STATE OF MISSISSIPPI
COUNTY OF MADISON

PERSONALLY APPEARED BEFORE ME, the undersigned authority in and for the said county and state, on this 7 day of February, 2013, within my jurisdiction, the within named Shirley Simmons and **Ronnie L. McGehee**, who acknowledged to me that they are President and Superintendent, respectively, of the **Madison County Board of Education**, and that for and on behalf of the said Madison County Board of Education, and as its act and deed, they executed the above and foregoing instrument, after first having been duly authorized so to do.

Lethia H. Reeves
NOTARY PUBLIC

My Commission Expires:



STATE OF MISSISSIPPI
COUNTY OF MADISON

PERSONALLY APPEARED BEFORE ME, the undersigned authority in and for the said county and state, on this ____ day of _____, 2013, within my jurisdiction, the within named Gerald Steen, who acknowledged to me that he is President of the **Madison County Board of Supervisors**, and that for and on behalf of the said Madison County Board of Supervisors, and as its act and deed, he executed the above and foregoing instrument, after first having been duly authorized so to do.

NOTARY PUBLIC

My Commission Expires:

[SEAL]

Other/2012/#15 Lease to Entergy Mississippi, Inc. for Electrical Distribution Line ROW



WR Name/Desc. FLORA-4659 HIGHWAY 22
 RELOCATE 3 PHASE O/H CIRCUIT

WR# 343403

Date: 1/21/03

WO/CEA#349108

LOC OFFICE 3050

County/Parish MADISON
 Section 16 Township 8N Range 1W

Right-of-Way

Yes No

Type Construction

OH
 UG Urban Rural

Load PT:

Customer Service Entrance Size

TAX DIST. 3

Pull off Loc. No. 5113274398

\$

Source PT:

Page 1 of 1

WR TYPE CUSTOMR

SO#

Map

Circuit No: 6D01

Designer FNG

Phone# 209-3743

Night Watcher SO#

Phase A, B, C

Contact Person ELAMIN BASHIR

Last Call Ref#

1" : 57.06'



EXHIBIT "A"

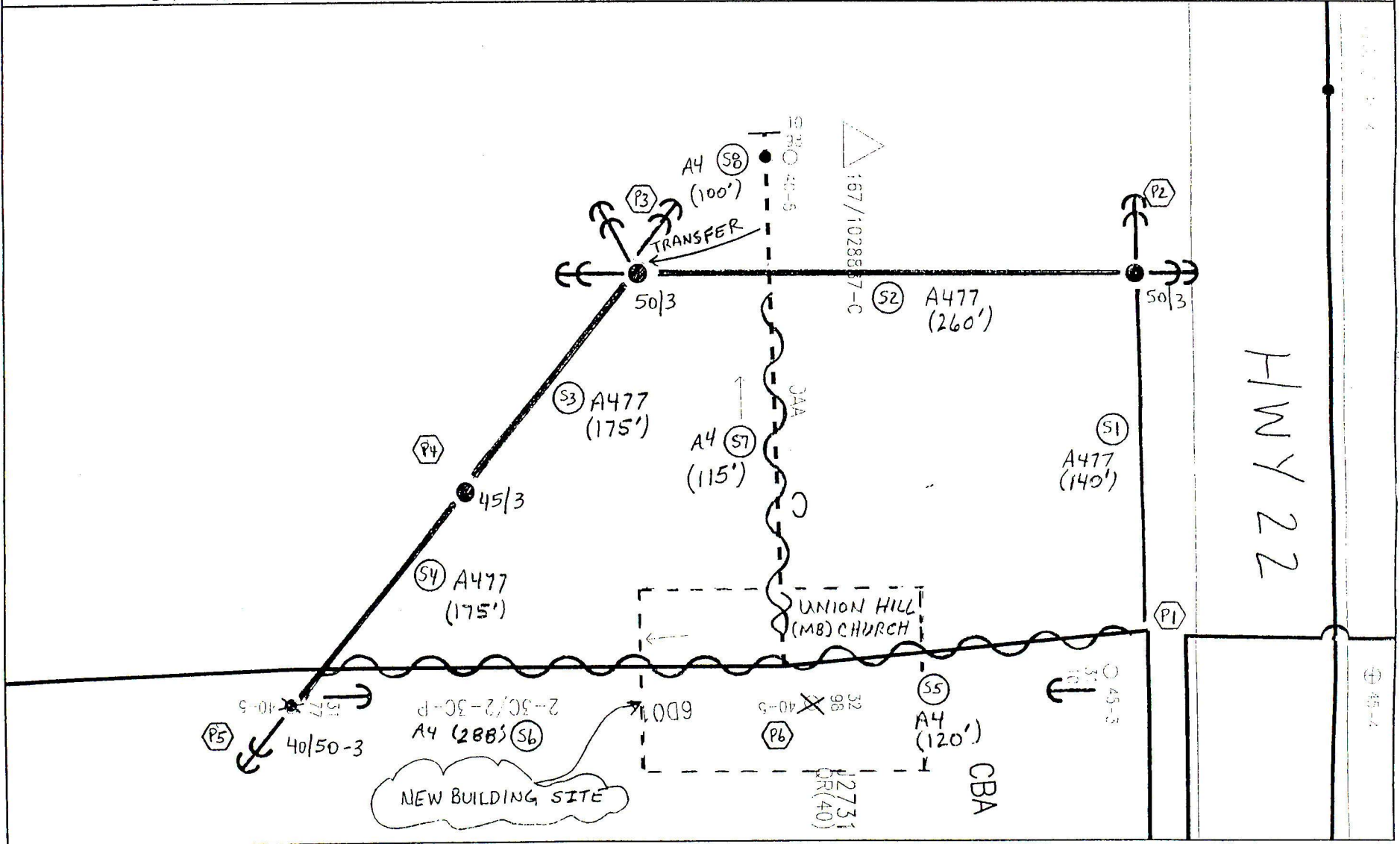

MADISON COUNTY SCHOOLS

Letitia H. Reeves
16th Section Land Manager

Ronnie L. McGehee
Superintendent of Education

117 Fourth Street • P.O. Box 159
Flora, Mississippi 39071
Toll Free: (800) 901-8379, Ext. 3005
Direct Line: (601) 879-3005
Receptionist: (601) 879-3000
Facsimile: (601) 879-8003
E-mail: lreeves@madison-schools.com

February 11, 2013

Madison County Board of Supervisors
ATTN: Ms. Cynthia Parker, Board Secretary
P.O. Box 404
Canton, MS 39046

RE: Documents for Board Approval

Dear Cynthia:

Enclosed please find the following documents:

1. Notice to Renew Residential Lease Contract to Jeff Broome and wife, Denise Broome, regarding Lot 36, Madison Oaks Subdivision, Part 2.
2. Notice to Renew Residential Lease Contract to Michael J. Farhart and wife, Karen L. Farhart, regarding, Lot 170, Sherbourne Subdivision, Part 4.

It is requested that the Board of Supervisors approve the enclosed documents at the upcoming Board of Supervisors' meeting to be held February 18, 2013. Should you have any questions or need anything further in this regard, please let me know. Thank you.

Sincerely,

Letitia Reeves
16th Section Land Manager

/lr

Enclosure

cc: Dr. Ronnie L. McGehee, Superintendent
Mr. Arthur Johnston, Chancery Clerk

INDEXING:

Lot 170, Sherbourne Subdivision, Part 4
Per Plat Cabinet D at Slide 119, City of Madison, Section 16, Township 7 North,
Range 2 East, Madison County, Mississippi
Parcel #072E-16A-002/23.00

LESSOR:

Madison County Board of Education
117 Fourth Street
Post Office Box 159
Flora, MS 39071
Telephone: (601) 879-3000

LESSEE:

Michael J. Farhart and
Karen L. Farhart
324 Highleadon Court
Madison, MS 39110
Telephone: (____)_____

PREPARED BY:

Madison County School District
117 Fourth Street
Flora, MS 39071
Telephone: (601)879-3000

**NOTICE TO RENEW
RESIDENTIAL LEASE CONTRACT**

This Notice to Renew is made and entered into on the _____ day of _____, 2013, by and between the Madison County, Mississippi, Board of Education Trustees of the Madison County School District 16th Section School Lands Trust (“Lessor”) and **Michael J. Farhart** and wife, **Karen L. Farhart**, (“Lessee”) according to the following terms and provisions:

A. Lessor and Lessee executed that certain Residential Lease Contract (the “Lease”) for a term of forty years, beginning on the 9th day of June, 2004, and terminating on the 8th day of June, 2044, (the “Primary Term”), covering a parcel of 16th Section Land as described therein which is recorded in the office of the Chancery Clerk of Madison County, Mississippi in **Deed Book 1809 at Page 866**, being located in Section 16, Township 7 North, Range 2 East, Madison County, Mississippi, and being more particularly described as:

Lot 170 of Sherbourne Subdivision, Part 4, a subdivision which is on file and of record in the office of the Chancery Clerk of Madison County at Canton, Mississippi in Plat Cabinet D at Slide 119, reference to which is hereby made in aid of and as a part of this description.

B. This Notice to Renew is executed pursuant to Paragraph (1) of the Lease whereby the Lease provided the Lessee with an option to renew the Lease for an additional term of twenty-five (25) years pursuant to Miss. Code Ann. § 29-3-69 (1972) as amended, commencing on the termination date of the Primary Term (the "Initial Termination Date").

C. NOW THEREFORE, the Lessor and Lessee do hereby agree to renew the Lease for an additional term of twenty-five (25) years commencing on the Initial Termination Date; and as a result, **the Lease shall now terminate on the 8th day of June, 2069** (the "Final Termination Date"). Said renewal shall be under the same terms, conditions, and stipulations set forth in the Lease, except the annual rental shall be based upon the fair market value of the subject property, as determined by a qualified appraiser selected by Lessor who performs his or her appraisal not more than twelve (12) months prior to the expiration of the Primary Term.

D. Except as amended by this Notice to Renew, the existing Lease shall stay in full force and effect and under the same terms conditions, annual rental, and stipulations set forth in the Lease until the Final Termination Date.

The Lease, as amended by this Notice to Renew, is ratified and confirmed as the valid and subsisting agreement of the parties but without waiver of remedies for any presently existing default.

In Witness Whereof, this Notice to Renew is executed by Lessor pursuant to an order entered upon its minutes and is executed by Lessee on the date first stated above.

LESSOR:

**MADISON COUNTY, MISSISSIPPI,
BOARD OF EDUCATION**

By: _____
Shirley Simmons, President of
the Board Of Education

By _____
Ronnie L. McGehee, Superintendent Of
Education

LESSEE:

Michael J. Farhart

Karen L. Farhart

Reviewed and approved by the Madison County Board of Supervisors, this the ____ day of _____, 2013.

By: _____
Gerald Steen, President
of the Board of Supervisors

ATTEST:

Arthur Johnston, Clerk

STATE OF MISSISSIPPI
COUNTY OF MADISON

PERSONALLY APPEARED BEFORE ME, the undersigned authority in and for the said county and state, on this ____ day of _____, 2013, within my jurisdiction, the within named **Gerald Steen**, who acknowledged to me that he is President of the **Madison County Board of Supervisors**, and that for and on behalf of the said Madison County Board of Supervisors, and as its act and deed, he executed the above and foregoing instrument, after first having been duly authorized so to do.

NOTARY PUBLIC

My Commission Expires:

[SEAL]

STATE OF MISSISSIPPI
COUNTY OF MADISON

PERSONALLY APPEARED BEFORE ME, the undersigned authority in and for the said county and state, on this ____ day of _____, 2013, within my jurisdiction, the within named **Shirley Simmons** and **Ronnie L. McGehee** who acknowledged to me that they are President of the Madison County Board of Education and Superintendent of Education, respectively, of the **Madison County School District**, and that for and on behalf of the said Madison County School District, and as its act and deed, they executed the above and foregoing instrument, after first having been duly authorized so to do.

NOTARY PUBLIC

My Commission Expires:

[SEAL]

STATE OF MISSISSIPPI
COUNTY OF _____

PERSONALLY APPEARED BEFORE ME, the undersigned authority in and for the said county and state, on this ____ day of _____, 2013, within my jurisdiction, the within named **Michael J. Farhart** and wife, **Karen L. Farhart**, who acknowledged to me that they executed the above and foregoing instrument.

NOTARY PUBLIC

My Commission Expires:

[SEAL]

Extension/2013/#691 Farhart

INDEXING:

Lot 36, Madison Oaks Subdivision, Part Two
Per Plat Cabinet D at Slide 81, City of Madison, Section 16, Township 7 North,
Range 2 East, Madison County, Mississippi
Parcel #072E-16B-179/00.00

LESSOR:

Madison County Board of Education
117 Fourth Street
Flora, MS 39071
Telephone: (601)879-3000

LESSEE:

Jeff Broome and
Denise Broome
487 Madison Oaks Drive
Madison, MS 39110
Telephone: (____)_____

PREPARED BY:

Madison County School District
117 Fourth Street
Flora, MS 39071
Telephone: (601)879-3000

**NOTICE TO RENEW
RESIDENTIAL LEASE CONTRACT**

This Notice to Renew is made and entered into on the _____ day of _____, 2013, by and between the Madison County, Mississippi, Board of Education Trustees of the Madison County School District 16th Section School Lands Trust (“Lessor”) and **Jeff Broome** and wife, **Denise Broome** (“Lessee”) according to the following terms and provisions:

A. Lessor and Lessee executed that certain Residential Lease Contract (the “Lease”) for a term of forty years, beginning on the 15th day of April, 2003, and terminating on the 14th day of April, 2043, (the “Primary Term”), covering a parcel of 16th Section Land as described therein which is recorded in the office of the Chancery Clerk of Madison County, Mississippi in **Deed Book 534 at Page 112**, being located in Section 16,

Township 7 North, Range 2 East, Madison County, Mississippi, and being more particularly described as:

Lot 29 of Madison Oaks Subdivision, Part Two, a subdivision which is on file and of record in the office of the Chancery Clerk of Madison County at Canton, Mississippi in Plat Cabinet D at Slide 81, reference to which is hereby made in aid of and as a part of this description.

B. This Notice to Renew is executed pursuant to Paragraph (1) of the Lease whereby the Lease provided the Lessee with an option to renew the Lease for an additional term of twenty-five (25) years pursuant to Miss. Code Ann. § 29-3-69 (1972) as amended, commencing on the termination date of the Primary Term (the "Initial Termination Date").

C. NOW THEREFORE, the Lessor and Lessee do hereby agree to renew the Lease for an additional term of twenty-five (25) years commencing on the Initial Termination Date; and as a result, **the Lease shall now terminate on the 14th day of April, 2068** (the "Final Termination Date"). Said renewal shall be under the same terms, conditions, and stipulations set forth in the Lease, except the annual rental shall be based upon the fair market value of the subject property, as determined by a qualified appraiser selected by Lessor who performs his or her appraisal not more than twelve (12) months prior to the expiration of the Primary Term.

D. Except as amended by this Notice to Renew, the existing Lease shall stay in full force and effect and under the same terms conditions, annual rental, and stipulations set forth in the Lease until the Final Termination Date.

The Lease, as amended by this Notice to Renew, is ratified and confirmed as the valid and subsisting agreement of the parties but without waiver of remedies for any presently existing default.

In Witness Whereof, this Notice to Renew is executed by Lessor pursuant to an order entered upon its minutes and is executed by Lessee on the date first stated above.

LESSOR:

**MADISON COUNTY, MISSISSIPPI,
BOARD OF EDUCATION**

By: _____
Shirley Simmons, President of the
Board Of Education

By _____
Ronnie L. McGehee, Superintendent Of
Education

LESSEE:

Jeff Broome

Denise Broome

Reviewed and approved by the Madison County Board of Supervisors, this the ____ day of _____, 2013.

By: _____
Gerald Steen, President of the
Board of Supervisors

ATTEST:

Arthur Johnston, Clerk

STATE OF MISSISSIPPI
COUNTY OF MADISON

PERSONALLY APPEARED BEFORE ME, the undersigned authority in and for the said county and state, on this ____ day of _____, 2013, within my jurisdiction, the within named **Shirley Simmons** and **Ronnie L. McGehee** who acknowledged to me that they are President of the Madison County Board of Education and Superintendent of Education, respectively, of the **Madison County School District**, and that for and on behalf of the said Madison County School District, and as its act and deed, they executed the above and foregoing instrument, after first having been duly authorized so to do.

NOTARY PUBLIC

My Commission Expires:

[SEAL]

STATE OF MISSISSIPPI
COUNTY OF MADISON

PERSONALLY APPEARED BEFORE ME, the undersigned authority in and for the said county and state, on this ____ day of _____, 2013, within my jurisdiction, the within named **Gerald Steen**, who acknowledged to me that he is President of the **Madison County Board of Supervisors**, and that for and on behalf of the said Madison County Board of Supervisors, and as its act and deed, he executed the above and foregoing instrument, after first having been duly authorized so to do.

NOTARY PUBLIC

My Commission Expires:

[SEAL]

STATE OF MISSISSIPPI
COUNTY OF _____

PERSONALLY APPEARED BEFORE ME, the undersigned authority in and for the said county and state, on this ____ day of _____, 2013, within my jurisdiction, the within named **Jeff Broome** and wife, **Denise Broome**, who acknowledged to me that they executed the above and foregoing instrument.

NOTARY PUBLIC

My Commission Expires:

[SEAL]

Extension/2013/#1056 Broome

February 12, 2013

Madison County Board of Supervisors
ATTN: Ms. Cynthia Parker, Board Secretary
P.O. Box 404
Canton, MS 39046

RE: Document for Board Approval

Dear Cynthia:

Enclosed please find a Notice to Renew Residential Lease Contract to Glen L. Simpson and Robin T. Simpson regarding Lot 23, Madison Oaks Subdivision, Part 2.

It is requested that the Board of Supervisors approve the enclosed document at the upcoming Board of Supervisors' meeting to be held February 18, 2013. Should you have any questions or need anything further in this regard, please let me know. Thank you.

Sincerely,

Letitia Reeves
16th Section Land Manager

/lr

Enclosure

cc: Dr. Ronnie L. McGehee, Superintendent
Mr. Arthur Johnston, Chancery Clerk

INDEXING:

Lot 23, Madison Oaks Subdivision, Part Two
Per Plat Cabinet D at Slide 81, City of Madison, Section 16, Township 7 North,
Range 2 East, Madison County, Mississippi
Parcel #072E-16B-173/00.00

LESSOR:

Madison County Board of Education
117 Fourth Street
Flora, MS 39071
Telephone: (601)879-3000

LESSEE:

Glen L. Simpson and
Robin T. Simpson
480 Madison Oaks Drive
Madison, MS 39110
Telephone: (____)_____

PREPARED BY:

Madison County School District
117 Fourth Street
Flora, MS 39071
Telephone: (601)879-3000

**NOTICE TO RENEW
RESIDENTIAL LEASE CONTRACT**

This Notice to Renew is made and entered into on the _____ day of _____, 2012, by and between the Madison County, Mississippi, Board of Education Trustees of the Madison County School District 16th Section School Lands Trust (“Lessor”) and **Glen L. Simpson** and wife, **Robin T. Simpson, formerly known as Robin L. Tracy** (“Lessee”) according to the following terms and provisions:

A. Lessor and Lessee executed that certain Residential Lease Contract (the “Lease”) for a term of forty years, beginning on the 3rd day of September, 2002, and terminating on the 2nd day of September, 2042, (the “Primary Term”), covering a parcel of 16th Section Land as described therein which is recorded in the office of the Chancery Clerk of Madison County, Mississippi in **Deed Book 518 at Page 907**, being located in Section

16, Township 7 North, Range 2 East, Madison County, Mississippi, and being more particularly described as:

Lot 23 of Madison Oaks Subdivision, Part Two, a subdivision which is on file and of record in the office of the Chancery Clerk of Madison County at Canton, Mississippi in Plat Cabinet D at Slide 81, reference to which is hereby made in aid of and as a part of this description.

B. This Notice to Renew is executed pursuant to Paragraph (1) of the Lease whereby the Lease provided the Lessee with an option to renew the Lease for an additional term of twenty-five (25) years pursuant to Miss. Code Ann. § 29-3-69 (1972) as amended, commencing on the termination date of the Primary Term (the "Initial Termination Date").

C. NOW THEREFORE, the Lessor and Lessee do hereby agree to renew the Lease for an additional term of twenty-five (25) years commencing on the Initial Termination Date; and as a result, **the Lease shall now terminate on the 2nd day of September, 2067** (the "Final Termination Date"). Said renewal shall be under the same terms, conditions, and stipulations set forth in the Lease, except the annual rental shall be based upon the fair market value of the subject property, as determined by a qualified appraiser selected by Lessor who performs his or her appraisal not more than twelve (12) months prior to the expiration of the Primary Term.

D. Except as amended by this Notice to Renew, the existing Lease shall stay in full force and effect and under the same terms conditions, annual rental, and stipulations set forth in the Lease until the Final Termination Date.

The Lease, as amended by this Notice to Renew, is ratified and confirmed as the valid and subsisting agreement of the parties but without waiver of remedies for any presently existing default.

In Witness Whereof, this Notice to Renew is executed by Lessor pursuant to an order entered upon its minutes and is executed by Lessee on the date first stated above.

LESSOR:

**MADISON COUNTY, MISSISSIPPI,
BOARD OF EDUCATION**

By: _____
Shirley Simmons, President of the
Board Of Education

By _____
Ronnie L. McGehee, Superintendent Of
Education

LESSEE:

Glen L. Simpson

Robin T. Simpson

Reviewed and approved by the Madison County Board of Supervisors, this the ____ day of _____, 2013.

By: _____
Gerald Steen, President of the
Board of Supervisors

ATTEST:

Arthur Johnston, Clerk

STATE OF MISSISSIPPI
COUNTY OF MADISON

PERSONALLY APPEARED BEFORE ME, the undersigned authority in and for the said county and state, on this ____ day of _____, 2013, within my jurisdiction, the within named **Gerald Steen**, who acknowledged to me that he is President of the **Madison County Board of Supervisors**, and that for and on behalf of the said Madison County Board of Supervisors, and as its act and deed, he executed the above and foregoing instrument, after first having been duly authorized so to do.

NOTARY PUBLIC

My Commission Expires:

[SEAL]

STATE OF MISSISSIPPI
COUNTY OF MADISON

PERSONALLY APPEARED BEFORE ME, the undersigned authority in and for the said county and state, on this ____ day of _____, 2013, within my jurisdiction, the within named **Shirley Simmons** and **Ronnie L. McGehee** who acknowledged to me that they are President of the Madison County Board of Education and Superintendent of Education, respectively, of the **Madison County School District**, and that for and on behalf of the said Madison County School District, and as its act and deed, they executed the above and foregoing instrument, after first having been duly authorized so to do.

NOTARY PUBLIC

My Commission Expires:

[SEAL]

STATE OF MISSISSIPPI
COUNTY OF _____

PERSONALLY APPEARED BEFORE ME, the undersigned authority in and for the said county and state, on this ____ day of _____, 2013, within my jurisdiction, the within named **Glen L. Simpson** and wife, **Robin T. Simpson**, who acknowledged to me that they executed the above and foregoing instrument.

NOTARY PUBLIC

My Commission Expires:

[SEAL]

Extension/2013/#1050 Simpson